

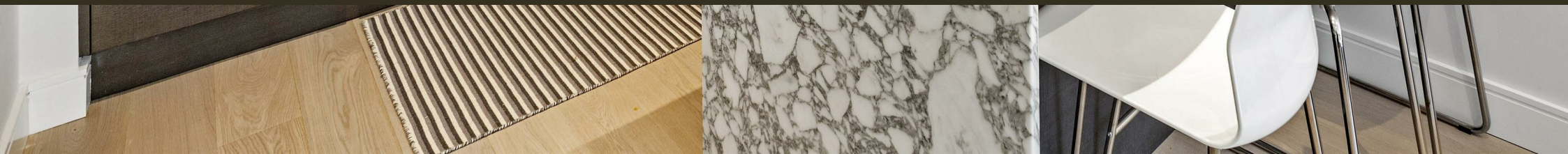

Lockside House, Chelsea Creek
Fulham SW6

GARTON JONES.COM



Lockside House, Chelsea Creek Fulham, SW6

GARTON JONES.COM

13 Park Street
Chelsea Creek
London
SW6 2FS

Sales +44 (0) 20 7824 7090
paul@gartonjones.com
www.gartonjones.com

£675 Per Week

A one bedroom apartment to rent of approx. 550sq.ft (51sq.m) in Lockside House, forming part of the highly popular Chelsea Creek development in Fulham. The property benefits from an open plan reception room with access to a private terrace, a smart kitchen with breakfast bar and Siemens integrated appliances including a wine cooler, induction hob, dishwasher, oven and fridge freezer. There is good storage including fitted wardrobes to the bedroom and a large utility cupboard housing a washer dryer and benefits from wood flooring, comfort cooling and under-floor heating. 24 hour concierge. Spa and fitness suite with Swimming pool. King's Road and Chelsea Harbour are easily accessible and Imperial Wharf Station is just a few minutes' walk.

** Please note the furniture may differ or not be included to that shown in current photos**

12-Month Tenancy

5-Week Security Deposit

Council Tax — London Borough Of Hammersmith & Fulham Council Tax — Band E

EPC Rating B (81)

EPC certificate available on request.

- One Double Bedroom
- 550sqft (51sqm)
- Open Plan Reception Room
- Private Terrace
- Integrated Appliances
- 24 Hour Concierge
- Onsite Spa & Fitness Suite
- Desirable Dockside Development
- Close to Imperial Wharf Overground Station

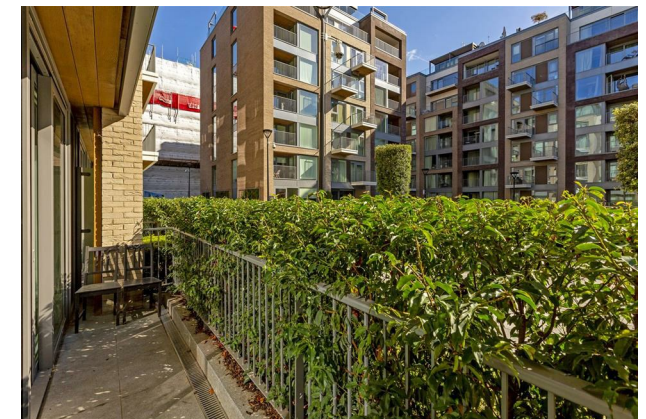

Lockside House

Approximate Gross Internal Area = 550 sq ft / 51 sq m

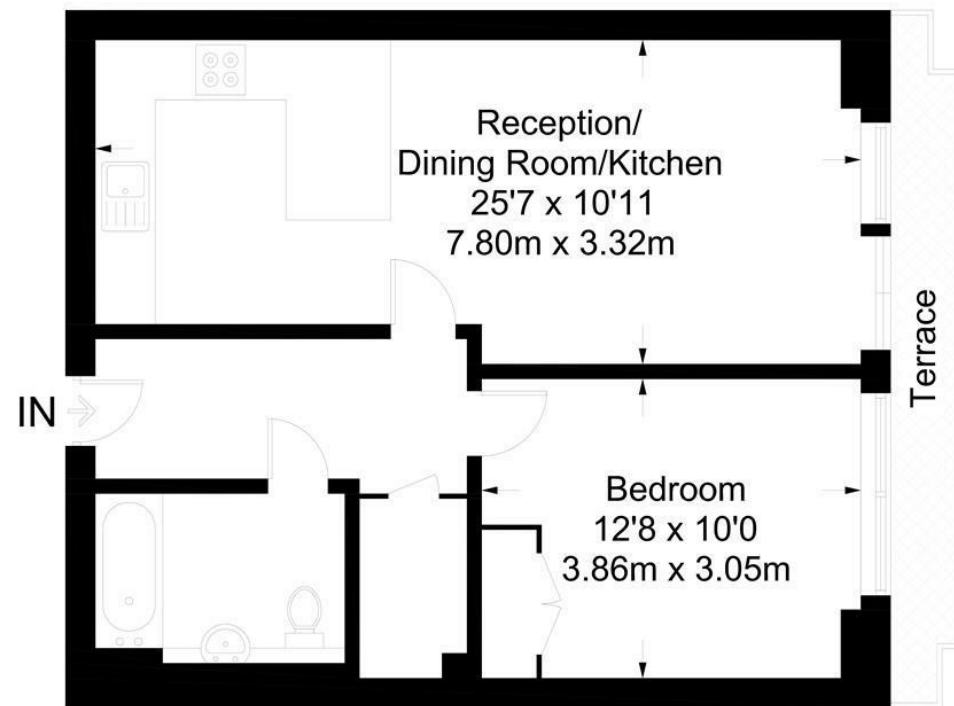

Ground Floor

Not to scale, for guidance only and must not be relied upon as a statement of fact.
All measurements and areas are approximate only and have been prepared in
accordance with the current edition of the RICS Code of Measuring Practice.

